

B O A R D O F S T U D I E S
NEW SOUTH WALES

2009

**HIGHER SCHOOL CERTIFICATE
EXAMINATION**

--	--	--	--	--

Centre Number

--	--	--	--	--	--	--	--	--

Student Number

Industrial Technology

Graphics Industries

General Instructions

- Reading time – 5 minutes
- Working time – $1\frac{1}{2}$ hours
- Write using black or blue pen
- Draw diagrams using pencil
- Board-approved calculators may be used
- Write your Centre Number and Student Number at the top of this page and pages 5, 7, 11 and 15

Total marks – 100

Section I Pages 2–9

60 marks

- Attempt Questions 1–3
- Allow about 55 minutes for this section

Section II Pages 11–17

40 marks

- Attempt Questions 4–5
- Allow about 35 minutes for this section

Section I

60 marks

Attempt Questions 1–3

Allow about 55 minutes for this section

Answer the questions in the spaces provided.

Use the following information to answer Questions 1–3.

Due to a slowing local and global economy, demand for IND-TECH’s products and services is decreasing. IND-TECH’s management has decided to investigate ways of maintaining sales.

Question 1 (20 marks)

(a) Name TWO strategies IND-TECH could consider to maintain sales. **2**

.....
.....

(b) Outline possible changes IND-TECH could make to its management structure in order to improve the company’s efficiency. **3**

.....
.....
.....
.....
.....
.....

Question 1 continues on page 3

Question 1 (continued)

- (c) Identify and describe a method IND-TECH could use to determine the reasons for the decrease in demand for their products and services. **4**

.....

.....

.....

.....

.....

.....

.....

.....

- (d) IND-TECH is considering changes to their employee working hours. **4**

Discuss the impact that government legislation could have on this proposal.

.....

.....

.....

.....

.....

.....

.....

.....

Question 1 continues on page 4

Question 1 (continued)

- (e) To improve efficiency, IND-TECH is considering implementing an emerging technology.

7

Suggest an appropriate technology and analyse the possible impact of this technology on both the company and its employees.

.....

.....

.....

.....

.....

.....

.....

.....

.....

.....

.....

.....

.....

.....

.....

.....

.....

.....

.....

.....

.....

.....

End of Question 1

Industrial Technology
Graphics Industries

--	--	--	--	--

Centre Number

--	--	--	--	--	--	--	--	--

Student Number

Section I (continued)

Question 2 (20 marks)

- (a) List TWO forms of effective workplace communication. **2**

.....
.....

- (b) Outline personnel issues that could arise if IND-TECH were to reduce its employees' working hours. **3**

.....
.....
.....
.....
.....
.....

- (c) IND-TECH plans to train its employees to be multi-skilled. **4**

Discuss how management could ensure a safe working environment during the training.

.....
.....
.....
.....
.....
.....
.....
.....

Question 2 continues on page 6

Question 2 (continued)

- (d) Describe TWO methods IND-TECH's management could use to determine the viability of introducing new products and services. **4**

.....

.....

.....

.....

.....

.....

.....

.....

- (e) Evaluate the use of computer software in the design and production of new products. **7**

.....

.....

.....

.....

.....

.....

.....

.....

.....

.....

.....

.....

.....

.....

.....

.....

.....

.....

.....

.....

.....

.....

End of Question 2

Industrial Technology
Graphics Industries

--	--	--	--	--

Centre Number

Section I (continued)

--	--	--	--	--	--	--	--	--

Student Number

Question 3 (20 marks)

- (a) List TWO advantages of using freehand drawings to present initial design ideas. **2**

.....
.....

- (b) Why are graphics often used in OHS signage? Use an example to support your answer. **3**

.....
.....
.....
.....
.....
.....

Question 3 continues on page 8

Question 3 (continued)

- (c) (i) Complete the following table to determine the weekly wages for a company. 2

<i>Employees</i>	<i>Number</i>	<i>Hourly rate (\$)</i>	<i>Hours worked</i>	<i>Weekly wages (\$)</i>
Administration staff	3	17	40	
Managers	2		40	4 400
Tradespeople		45	40	12 600
Apprentices	2	16		1 280
			<i>Total</i>	

- (ii) Using the information in the table, graph the weekly wages for each group of employees. 2

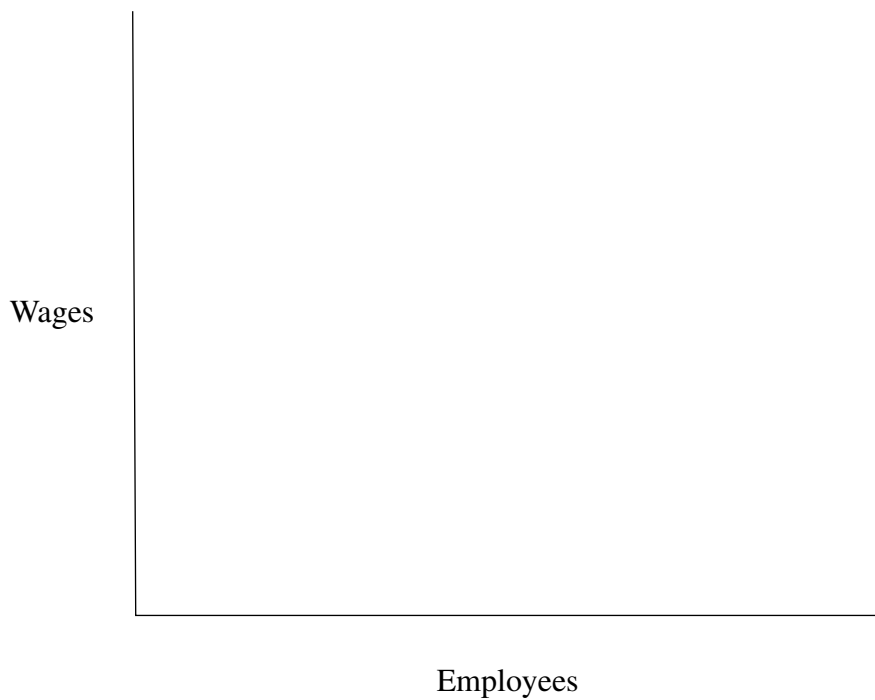

Question 3 continues on page 9

Question 3 (continued)

- (d) Describe the advantages of using word processing software to produce a management folio. 4

.....
.....
.....
.....
.....
.....
.....
.....

- (e) Identify and evaluate the types of computer graphics that could be used in the production of IND-TECH's annual report. 7

.....
.....
.....
.....
.....
.....
.....
.....
.....
.....
.....
.....
.....
.....
.....
.....
.....
.....
.....
.....
.....

End of Question 3

BLANK PAGE

Industrial Technology
Graphics Industries

--	--	--	--	--

Centre Number

--	--	--	--	--	--	--	--	--

Student Number

Section II

40 marks

Attempt Questions 4–5

Allow about 35 minutes for this section

Answer the questions in the spaces provided.

Question 4 (20 marks)

(a) What do the architectural symbols below represent?

2

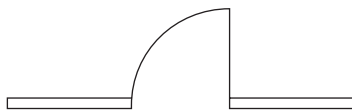

.....

(b) Outline the advantages of using three-dimensional drawings.

3

.....
.....
.....
.....
.....
.....

Question 4 continues on page 12

Question 4 (continued)

(c) A camera is shown.

4

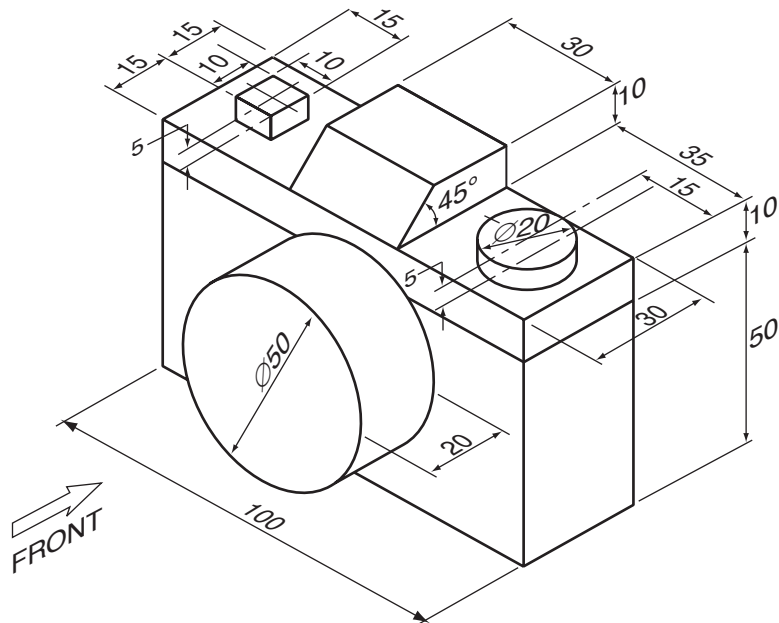

Main Elevation of Camera, Elizabeth McHugh, Complete Graphics, Thomson New House (Cengage Learning), 2005, reproduced by permission

Using third angle projection, sketch a top view and a front view of the camera.



Question 4 continues on page 13

Question 4 (continued)

(d) A top view and a front view of a stepped block are shown.

4

Complete the mechanical perspective drawing.

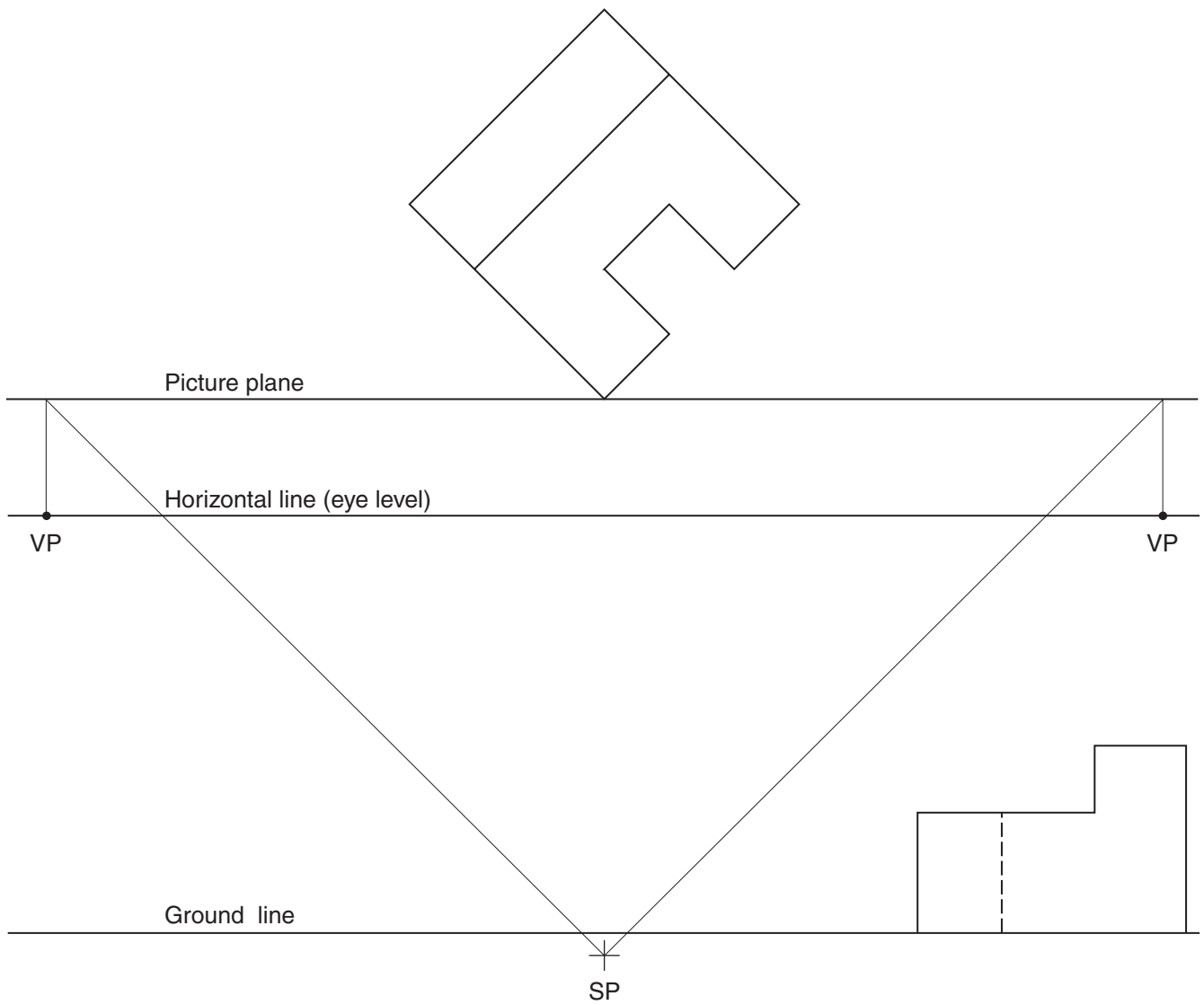

Question 4 continues on page 14

--	--	--	--	--

Centre Number

--	--	--	--	--	--	--	--	--

Student Number

Section II (continued)

Question 5 (20 marks)

- (a) Why do engineers use section drawings? **2**

.....

.....

.....

.....

- (b) Explain the difference between first angle projection and third angle projection. **3**

.....

.....

.....

.....

.....

.....

- (c) Discuss the importance of drawing standards for designers and manufacturers. **4**

.....

.....

.....

.....

.....

.....

.....

.....

.....

.....

Question 5 continues on page 16

Question 5 (continued)

(d) A bearing has been drawn in orthogonal projection.

4

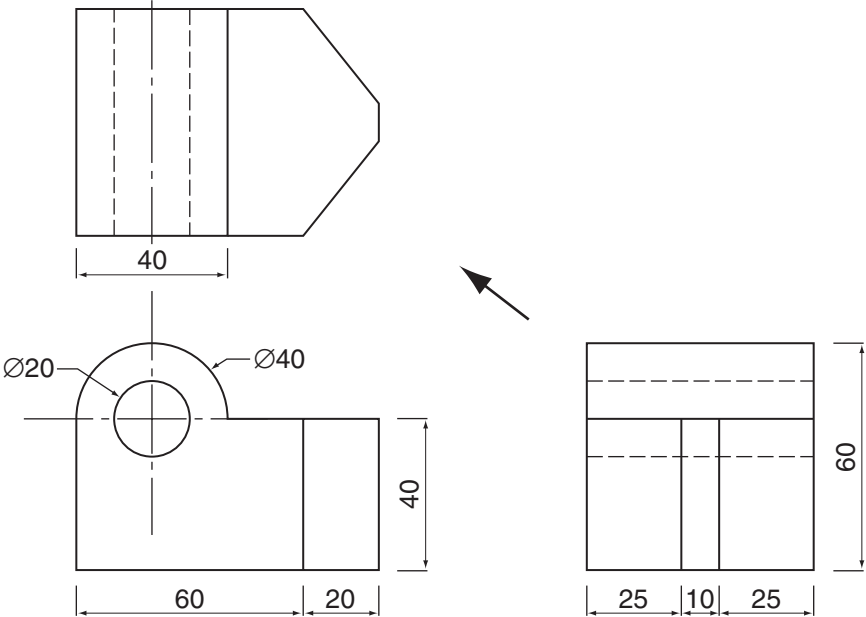

Sketch the bearing in isometric projection.

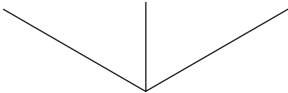

Question 5 continues on page 17

BLANK PAGE