

MAJOR DESIGN PROJECT

The following images are indicative of projects in the range of band 5/6. They are shown for information purposes only and are in no way prescriptive nor exemplary. It is important to recognise that a Major Design Project is the developmental work recorded within the folio as well as the final product of that development.



FINAL PRODUCT



FINAL PRODUCT

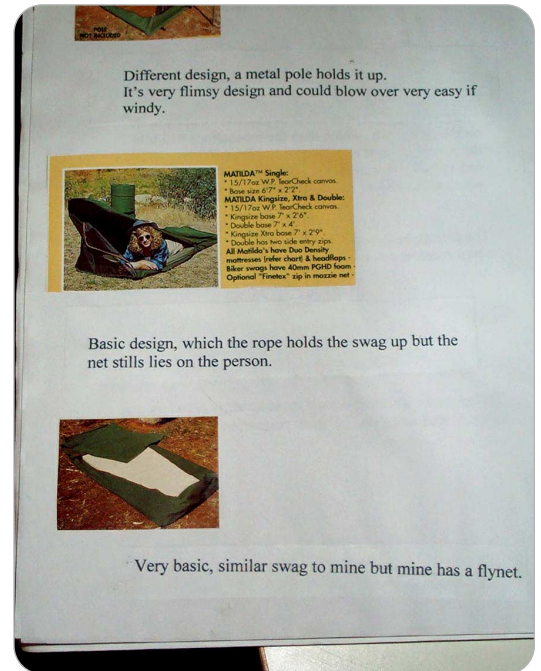

EVALUATING EXISTING DESIGNS

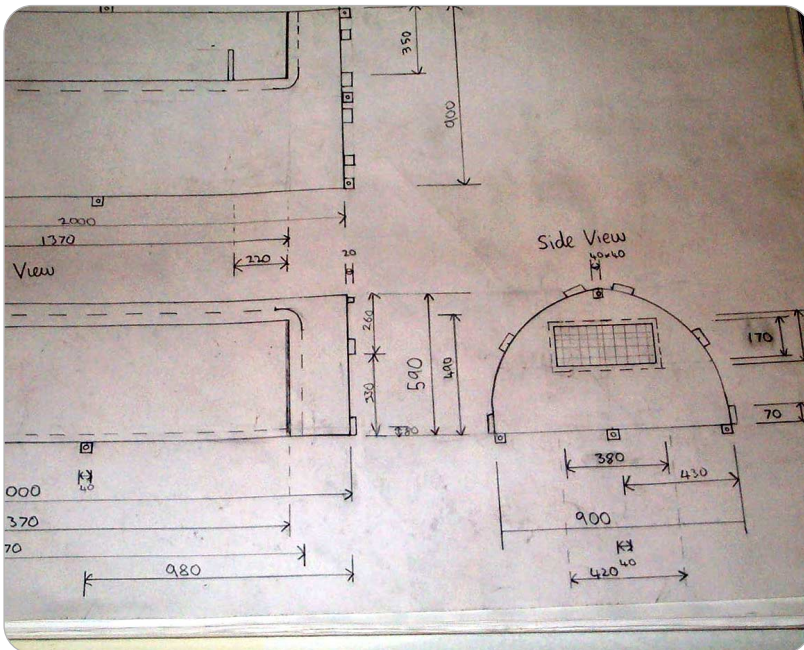

SAMPLES OF FINAL DESIGN DRAWINGS



EXPERIMENTATIONS

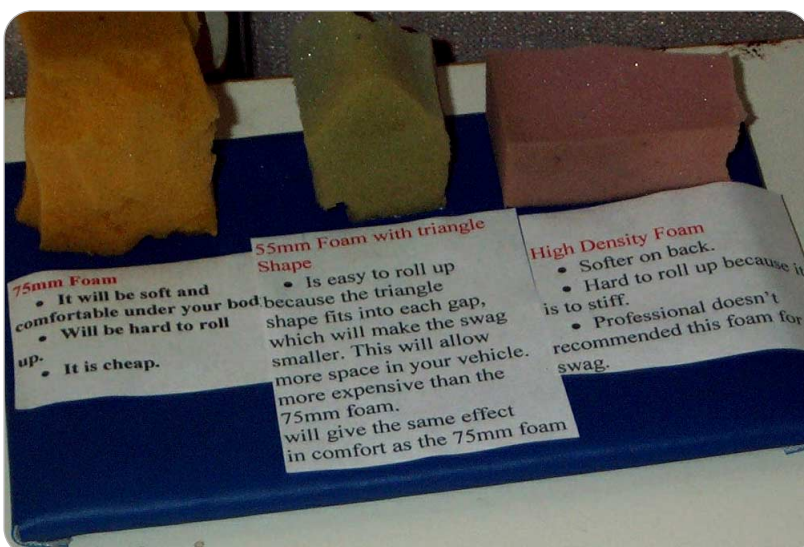

EVALUATING RESOURCES

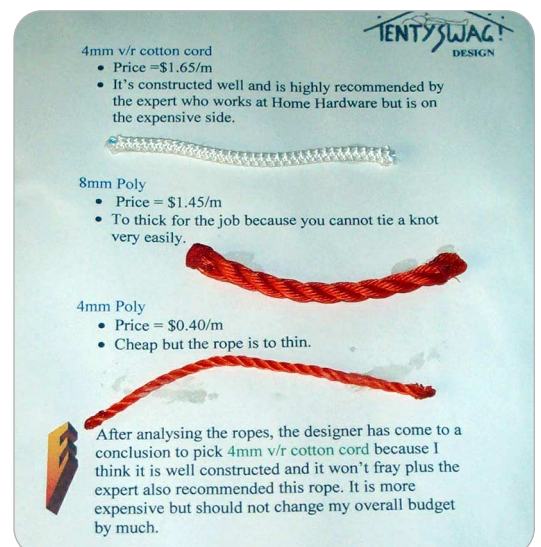

EVALUATING EXPERIMENTATION



FINAL PRODUCT

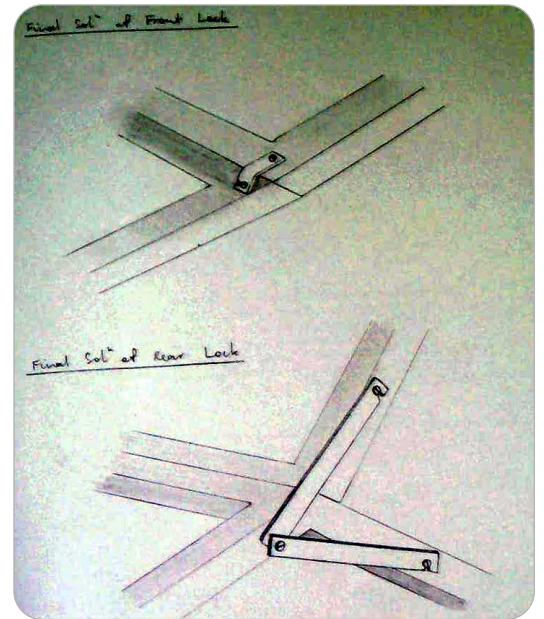

CONCEPT DEVELOPMENT

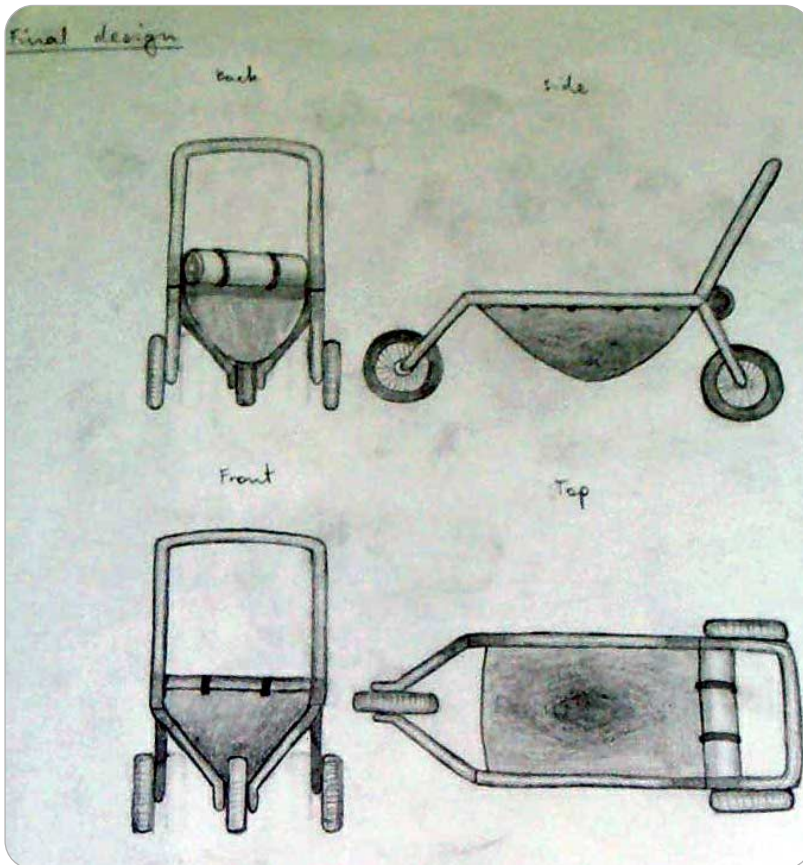

FINAL DESIGN



PROTOTYPING OF CARRIER



FINAL PRODUCT

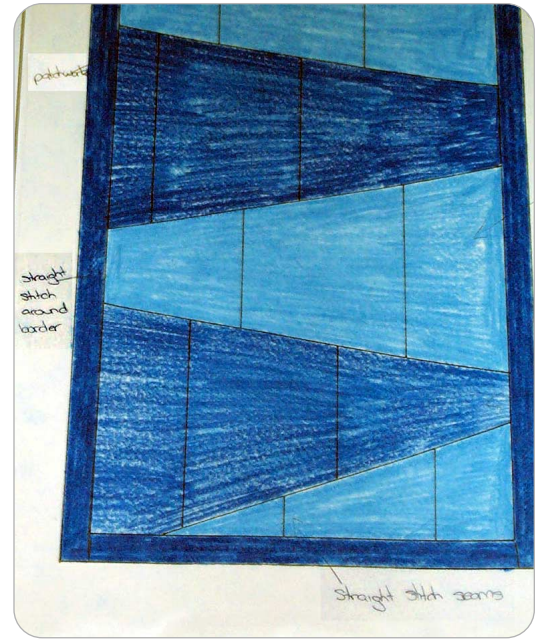

CONCEPT DEVELOPMENT



DESIGN CONCEPTS

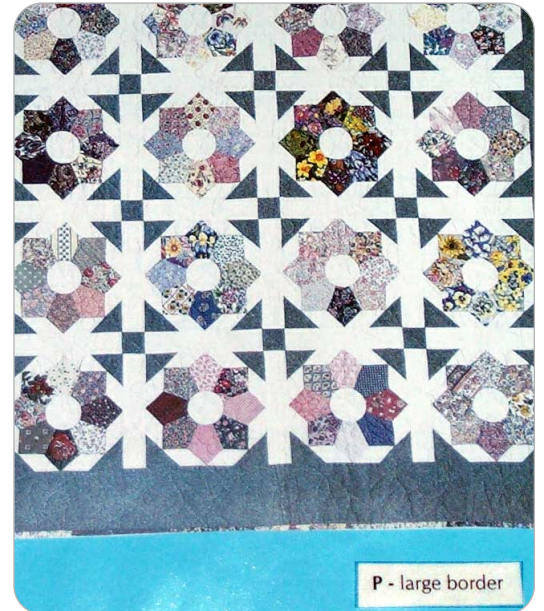

EXPERIMENTATION



PROTOTYPING



PROTOTYPING